



PRODUCT OVERVIEW

PRESSURE MEASUREMENT

MAC Sensor Co.,LTD.
Changsha City,Hunan,China
<http://www.macsensor.com>
TEL: +86-731-89975636 / 89975645

MAC Sensor Co.,LTD.

DP802 Standard Industrial Air Differential Pressure Transmitter



Characteristics

- ☆ Accuracy: $\leq \pm 0.5\% \text{F.S.}$
- ☆ Digital temperature compensation
- ☆ Imported chip assembled
- ☆ Strong anti-humidity and water-resistance
- ☆ Advanced circuit linearity
- ☆ Compact and easy to install
- ☆ IP65 enclosure
- ☆ Pressure sensitive

Applications

- ★ Industrial dust removal equipment
- ★ Purification plant
- ★ Blow down expander
- ★ Leak detection device
- ★ HAVC Air differential pressure
- ★ Wind pipe pressure measurement
- ★ Wind machine
- ★ Building control

Profiles

DP802 is a differential pressure transmitter with high reliability, stability, and accuracy, designed for monitoring pressure or differential pressure in industrial and OEM applications, including electrical power, environmental protection, dust removal, textile, leakage detection and etc..

It adopts imported chip and is made by advanced technology and processes. The circuit linearity and temperature compensation technologies make it better performance. It is compact with stable structure and light weight. This product is suitable for measurement of various dry and non-corrosive gases with high measurement accuracy.

Besides, its installation is very simple. There are M4 screw mounting holes on both sides of the housing, and the air nozzle is also threaded. The user can choose to fix it with screws or M10×1.5 nuts.

Specifications

Model	DP802				
Parameter					
Accuracy	$\leq \pm 0.25\%F.S$ (by customized); $\leq \pm 0.5\%F.S$ (Typical);				
Pressure Range	0-100Pa...200KPa max or $\pm 100Pa$...200KPa				
Working Temp.	$-10^{\circ}C \sim 80^{\circ}C$ at $25^{\circ}C$				
Temp. compensation	$-10^{\circ}C \sim 80^{\circ}C$				
Medium compatible	Dry and non-corrosive gases				
Electrical Wire	2 Wires	3 Wires		4 wires	
Output	4~20mA	0~5V	0~10 V	0.5-4.5V	RS485 MODBUS
Power Supply	8-30V with potentiometer; 24-30V without potentiometer		5Vdc	8-30V with potentiometer; 24-30V without potentiometer	
Electrical connection	Fixed cable outlet				
Pressure connection	$\Phi 8$ gas port, $\Phi 6$ gas port , quick connector optional				
Housing material	Aluminum				
Pressure Type	Differential Pressure				
IP Rating	IP65				

Dimension and Drawing

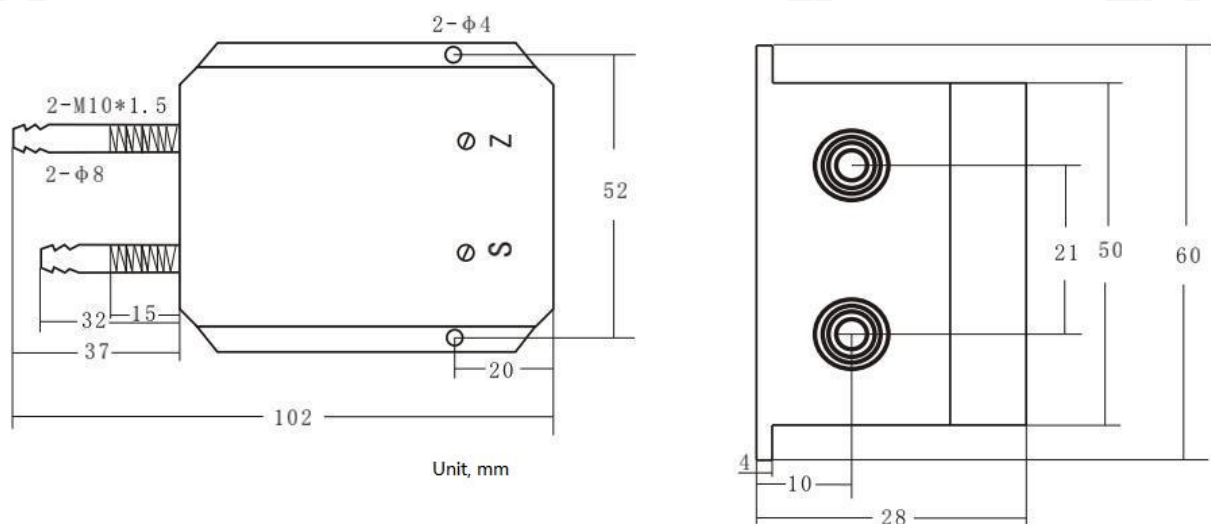

Electrical Connections

Wiring for current and voltage output

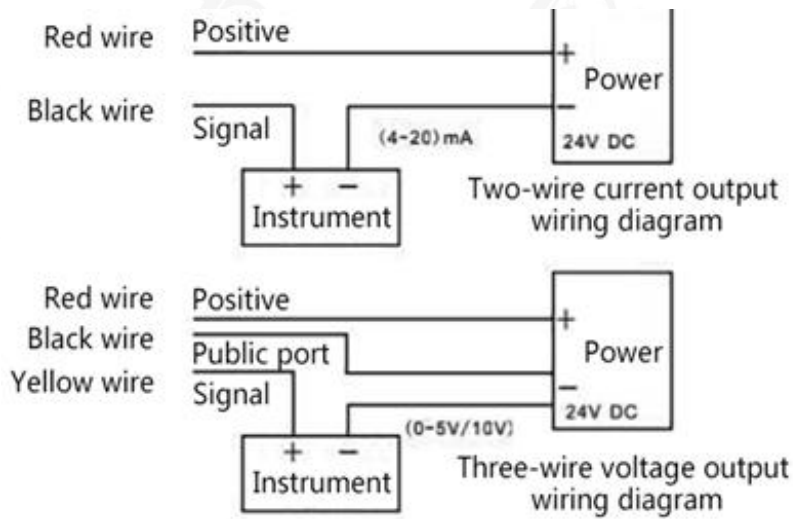

Wiring for RS485 output

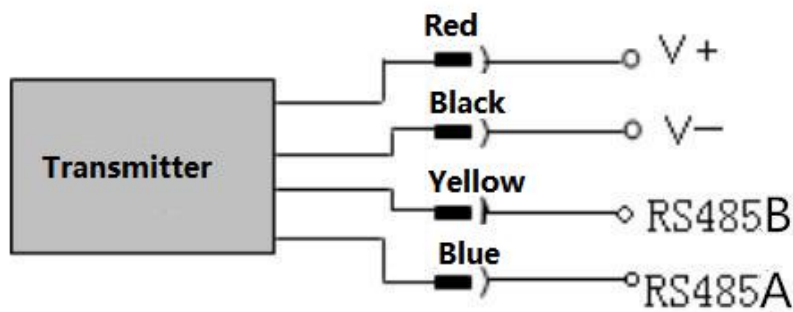

Part Number Code Table For Pressure Range

000	±1	009	±250	018	50	027	600
001	±2	010	±300	019	100	028	700
002	±5	011	1	020	150	029	800
003	±10	012	2	021	200		
004	±20	013	5	022	250		
005	±50	014	10	023	300		
006	±100	015	20	024	350		
007	±150	016	25	025	400		
008	±200	017	30	026	500	X	Customized

Order Information

P/N	DP802	010	E5	S40	K	1	1	39	P1
Selection	(Model)								
Range	Refer to <i>PART NUMBER CODE TABLE FOR PRESSURE RANGE</i> on previous page and select your requested range code here.								
Output	E7=0-10V(3 wire) E5=4-20mA(2 wire) E6=0-5V(3 wire) E8=0.5-4.5V (3 wire) E11=RS485 Modbus RTU X= By customized								
Power Supply	S12=8-30VDC S40=24-30VDC S6=5VDC X= By customized								
Pressure unit	A=Pa K=kPa B=bar								
Accuracy	1=0.5%F.S 2=0.25%(by customized)								
Cable Length	0=Cable 0m 1=Cable 1m 2=Cable 2m X=Cable x m								
Pressure Connection	39= Ø6 gas mouth 40= Ø8 gas mouth 41= Quick connector X= By customized								
Max Static Pressure	P1=Standard by DP range								